

Overview

The Varia Angle-Select Tabletop stands are designed for 8" VARIA-80, 10.1" VARIA-100, & 15.6" VARIA-150 Touch Panels, and give them a sleek & modern tabletop solution that can be installed at one of three angles to best suit the users' needs.



FIG. 1 Varia Touch Panel on Angle-Select Tabletop Stand

Model Availability & Compatibility

ANGLE-SELECT TABLETOP STANDS	
VARIA-ACS-810A (AMX-UMT8111)	VARIA-80 Touch Panel (AMX-UTP0811) VARIA-100 Touch Panel (AMX-UTP1011) VARIA-100N Touch Panel (AMX-UTP1011N)
VARIA-ACS-150A (AMX-UMT1511)	VARIA-150 Touch Panel (AMX-UTP1511) VARIA-150N Touch Panel (AMX-UTP1511N)

Other Models Available

FIXED TABLETOP STANDS	
VARIA-ACS-80F (AMX-UMT0801)	VARIA-80 Touch Panel (AMX-UTP0811)
VARIA-ACS-100F (AMX-UMT1001)	VARIA-100 Touch Panel (AMX-UTP1011) VARIA-100N Touch Panel (AMX-UTP1011N)

Installation

Varia Fixed Tabletop Stands are easily installed with the supplied hardware and a Philips-head screwdriver.

1. Place the panel face-down on a soft cloth and arrange the panel so that the top of the touch panel is closest to you.

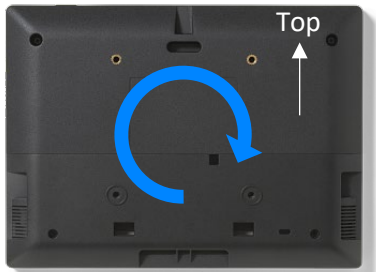

FIG. 2 Varia Touch Panel, rear

2. If they are installed, remove two small screws from the lower cover.

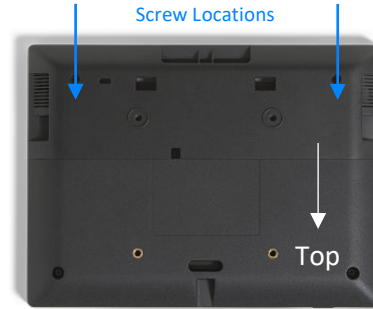

FIG. 3 Rear cover screws, if installed

3. Place your thumbs on the rectangular access holes, and push the lower cover away from you. Do not discard, this will be reinstalled later.

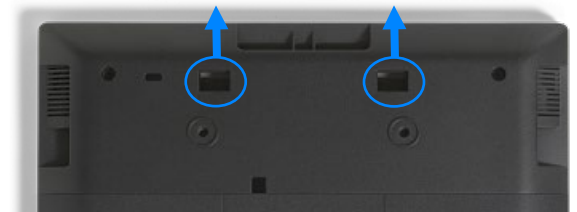

FIG. 4 Rear Cover Removal

4. Rotate the panel back around so the bottom is closest to you.
5. Route the networking cable through the base first, and then plug the RJ-45 connector into the back of the touch panel.



FIG. 5 Angle-Select Tabletop Stand Base

6. Reinstall the lower cover, first snapping it into place. Optionally, two small screws supplied in the hardware accessory bag may be installed. Make sure the cable routes out the bottom of the lower cover.
7. Screw the mount to the rear of the panel using the supplied screws.

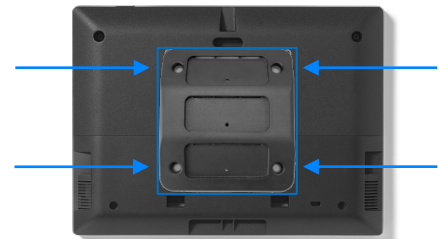

FIG. 6 Mounting Plate Installation

NOTE: The three slots should be oriented UP and the set screw holes should be oriented DOWN.

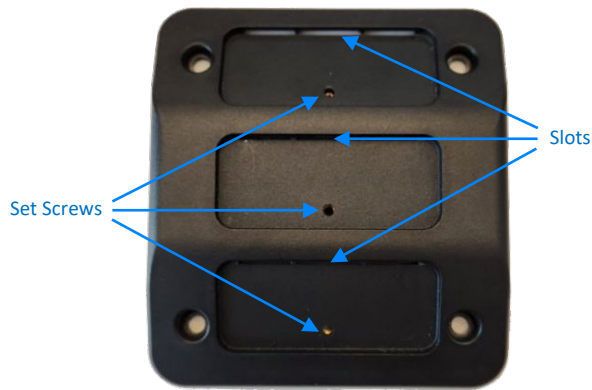

FIG. 7 Mounting Plate; Slot & Set Screw Locations

8. Select the best angle for installation. The Angle-Select Tabletop Stand can be installed at one of three (3) angles:
 - a. Upright 60° angle
 - b. Mid 45° angle
 - c. Low 30° angle



FIG. 9 Varia Touch Panels on Angle-Select Tabletop Stand, various angles

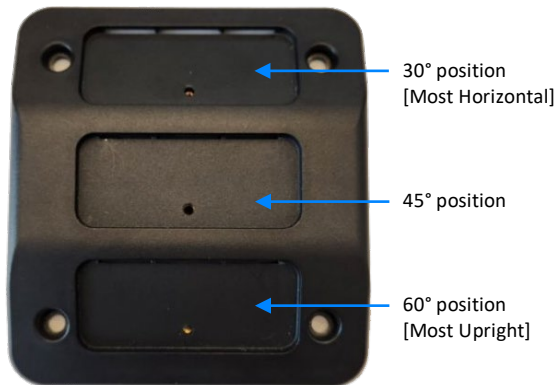

FIG. 8 Mounting Plate; Install Angle Options

9. Insert the base into the desired position. Insert the tab first and set flat against the mount.
10. Install the supplied set screw to lock the base in the desired position.

Removing

To remove the panel, follow the installation directions in reverse.

