



# Application Data Sheet

# ASB4128

## SPECIFICATIONS

### ACOUSTIC & ELECTRICAL SPECS:

PARALLEL-DRIVE MODE:  
Nominal Impedance: ..... 4 ohms  
Sensitivity: ..... 103 dB-SPL

DISCRETE-DRIVE MODE:  
Nominal Impedance: ..... 2 x 8 ohms

### POWER HANDLING:

PARALLEL-DRIVE MODE:		DISCRETE-DRIVE MODE:		
	<u>2 hr AES</u>	<u>100 hr AES</u>	<u>2 hr IEC</u>	<u>100 hr AES</u>
LF	1000 W	600 W	2 x 500 W	2 x 300 W

### SYSTEM COMPONENTS:

Drivers: ..... 2 x 2042H 460 mm (18 in)

### PHYSICAL SPECIFICATIONS:

Enclosure Dimensions: ..... 1094 x 561 x 816 mm  
H x W x D (43.1 x 22.1 x 32.2 in.)  
Net Weight: ..... 64.9 kg (143 lb)

*Refer to the product specification sheet for specification test and measurement conditions.*

## CHANGING CROSSOVER MODE (From Parallel to Discrete Drive)

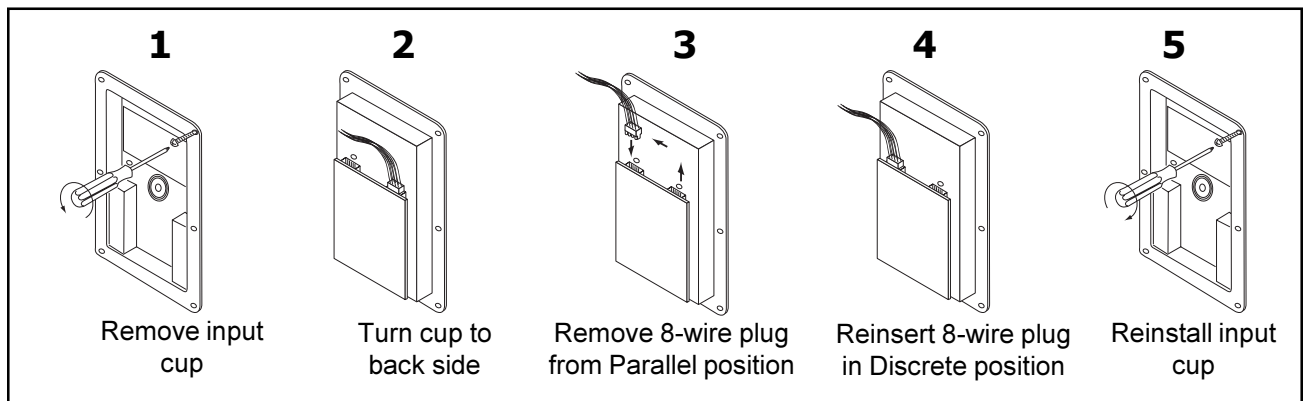

## ACCESSORIES

Included: Secondary JBL Grille Badge (orange), adheres on top of stock Grille Badge. Note: Stock grille badge is rotatable.

Optional: **229-00009-01** -- 3 pcs 10 mm diameter x 35 mm-thread forged shoulder steel eyebolts.  
Check [www.jblpro.com/ae](http://www.jblpro.com/ae) for rigging hardware.

### BOLT WARNING FOR BRACKETS AND RIGGING

Do NOT use the stock 10 mm flathead screws that come with the cabinet for attaching brackets or rigging. Use only load-rated bolts, which may come with the bracket or rigging system.

## SUSPENSION WARNING

Suspending Cabinet To Be Done Only by  
Qualified Personnel Using Safe Rigging Practices.

### DETAILED DIMENSIONAL DIAGRAM

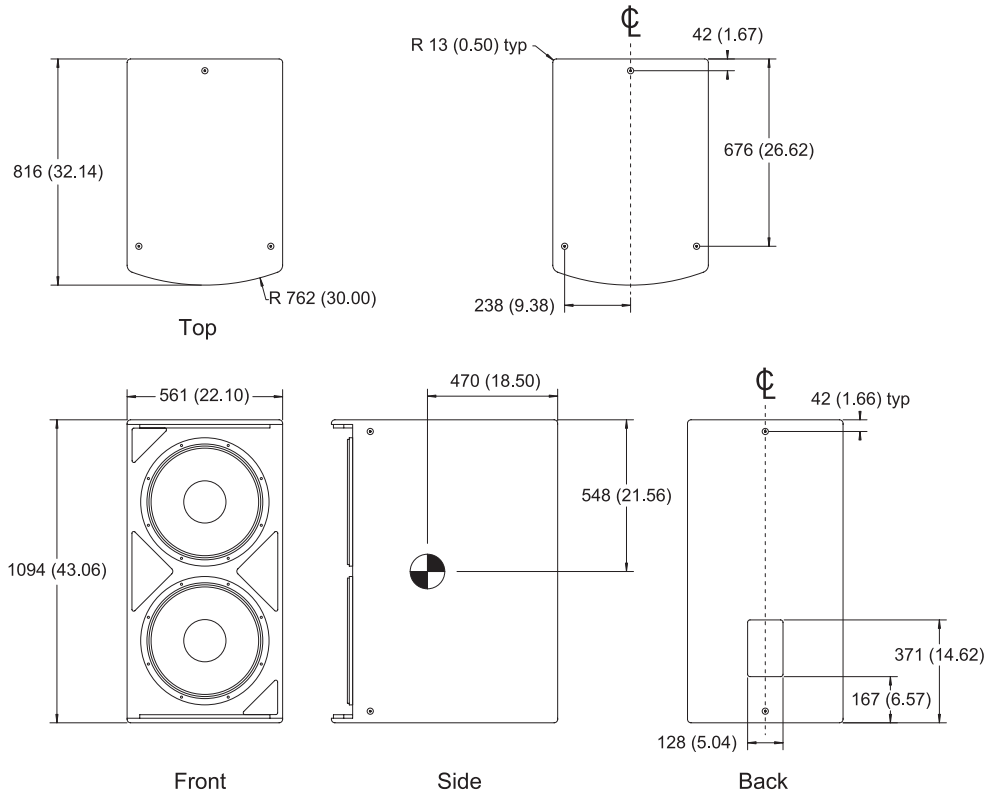

### ENVIRONMENTAL CONSIDERATIONS

This loudspeaker is not intended for use as an outdoor speaker. An outdoor version of this speaker can be ordered from JBL. Contact JBL Professional for information.

### RECOMMENDED DSP SETTINGS

Check [www.jblpro.com/ae](http://www.jblpro.com/ae) for the most recent recommended DSP tunings.

*Note: Be aware that the end-result of identical panel settings on different digital signal processors can vary.*



HA Harman International Company

JBL Professional  
8500 Balboa Blvd.  
Northridge, CA 91329 U.S.A.  
818-894-8850

339390-026  
Ver A 04/02